



DESCRIPTION

One of the smallest pressure switches in the market offering an integrated Deutsch receptacle. Plug in a mating Deutsch DT06-2S plug for an instant solution to the constant water spray present in mobile applications.

FEATURES

- Creep / Blade contact switch
- Diaphragm/Piston combination
- Integrated Deutsch receptacle
- Gold contact available

APPLICATIONS

- Mobile equipment
- Street sweepers
- Cement trucks
- Aerial booms

Specifications

Electrical	100 VA, 42 VDC, Max 4A Optional: Gold Contact (0.4VA, 30VDC)
Switch Type	Blade Contact
Protection	IP67
Mating Connector	DT06-2S
Media Temperature Range	Nitrile: -20°F to 180°F (-29°C to 82°C) Viton: 23°F to 248°F (-5°C to 120°C) HNBR: -20°F to 248°F (-29°C to 120°C) EPDM: -20°F to 248°F (-29°C to 120°C)
Ambient Temperature Range	-40°F to 248°F (-40°C to 120°C)
Mechanical Life Expectancy	1,000,000 Cycles @ 1000 PSI (69 BAR)
Diaphragm Material	Standard: Nitrile Optional: Viton, EPDM, HNBR
Housing Material	Zinc Plated Steel (Optional Stainless Steel)
Maximum Overpressure	9000 PSI (600 BAR)
Repeatability at 20°C (68°F)	5 psi to 14.5 psi = +/- 1.5 psi 12.5 to 145 psi = +/- 5 psi 146 to 350 psi = +/- 11 psi 351 to 1000 psi = +/- 30 psi 1001 to 2175 psi = +/- 65 psi
Weight	0.15 lbs (0.06 kg)

Pressure Range

Set Point	
PSI	BAR
5 - 2175	0.3 - 150

Dimensions

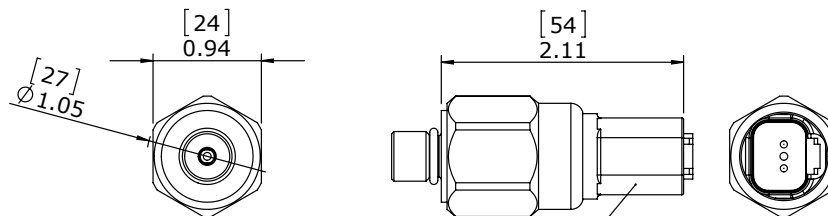

Wiring Code

CONTACT	DEUTSCH RECEPTACLE
COMMON	PIN A
NORMALLY CLOSED	PIN B
NORMALLY OPEN	PIN B

DT04-2P, 2 POLE RECEPTACLE MATING; DT06-2S, 2 POLE PLUG

Ordering Information

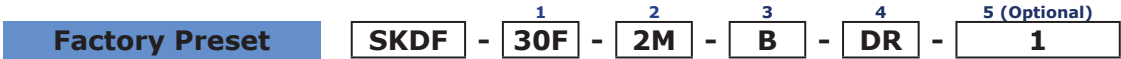

1 - Pressure Selection

Insert set point value XXX followed by: R, F, BR, or BF

Set Point	Direction	Description
XXXX	R	PSI Rising Pressure
	F	PSI Falling Pressure
	BR	BAR Rising Pressure
	BF	BAR Falling Pressure

2 - Thread Options:

- 2M** - 1/8 NPT male
- 4M** - 1/4 NPT male
- 2G** - 1/8 BSPP male, G1/8
- 4G** - 1/4 BSPP male, G1/4
- 4S** - 7/16-20 SAE male, with O-ring seal
- 6S** - 9/16-18 SAE male, with O-ring seal
- M10** - M10 X 1.0 male (to be used with seal ring or crush washer, not supplied)
- M12** - M12 X 1.5 male (to be used with seal ring or crush washer, not supplied)

3 - Circuit:

- A** - SPST (Normally Open)
- B** - SPST (Normally Closed)

4 - Electrical Termination:

DR - Integrated Deutsch Receptacle - Mates with DT06-2S

5 - Options (Omit if not required):

- 1** - Viton® Diaphragm
- 2** - EPDM Diaphragm
- 4** - HNBR Diaphragm
- 7** - Gold Contact, 0.4 VA, 30 VDC
- 20** - Seal Adjustment Screw
- OC** - Oxygen Cleaned
- SR** - Snubber



Note: Please see page 62 for other available options